

OREGON PUBLIC LAND CORNER REPORT / RESTORATION REPORT
Tillamook County Surveyor's Office

BOOK 8 213

SECTION: 29	TOWNSHIP: 1 South	RANGE: 10 West
COUNTY: Tillamook		DATE:
CORNER DESIGNATION: Center North 1/16 th corner of Section 29, Township 1 South, Range 10 West, Willamette Meridian; Tillamook County, Oregon.		(Please check one)
		<input checked="" type="checkbox"/> Condition Report Only
		<input type="checkbox"/> Restoration
		<input type="checkbox"/> Rewitness
		<input type="checkbox"/> Unrecorded
		<input type="checkbox"/> Reset at surface
		<input type="checkbox"/> Referenced Out

Previous Rewitnesses, Restorations and Surveys, etc...
Map B-3635 (2014)

History, condition, and sources

In 2014 (Map B-3635) Terry Jones PLS 2507 Set a 1" galvanized iron pipe with a 2 1/2" brass cap stamped "CN 1/16 S29 LS 2507 2014" as shown hereon and established three accessories. In 2024 (Field Book MR 17 pg. 21-24 12/2024) the Tillamook County Surveyors Office Found a 2 1/2" brass cap stamp as shown hereon to be in good condition. The references are listed here below.

- Found:** (Map B-3635 2014) steel post North 3' **now** found bent over restraightened and put back to its original position.
- Found:** (Map B-3635 2014) 22" dia. fir scribed "CN 1/16 S29 BT" N 59° 34' W 10.67' **now** 24" dia. fir stump 2' tall with healed scar.
- Found:** (Map B-3635 2014) 20 dia. hemlock scribed "CN 1/16 S29 BT" N 72°05' E 7.52' **now** 22" dia. scribing visible nail with washer between the B and the T partially visible.

New accessories set:

Tied monument directly using GPS in Oregon North Zone NAD 83/91 grid coordinates in US Survey feet. Coordinates provided hereon are given in WGS 84 Latitude and Longitude.

Latitude: 45°27'37.06571"
Longitude: -123°56'15.75443"

No new bearing tress available.

Pictures of Found Monuments:



Location: ± 30' North of logging road #270

Tillamook County Surveyor office: 1510 3rd Street Suite C, Tillamook, OR. 97141

Party Chief: Travis Porter, Tillamook County Surveyors Office

Witnesses: Michael Rice P.L.S. 86926, Tillamook County Surveyor
Kael Poklikuha, Tillamook County Survey Technician

Notes: Digital images taken of monument and accessories.

SURVEYOR'S SEAL

REGISTERED
PROFESSIONAL
LAND SURVEYOR

OREGON
DECEMBER 11, 2012
MICHAEL R. RICE
86926

RENEWAL 12-31-2026

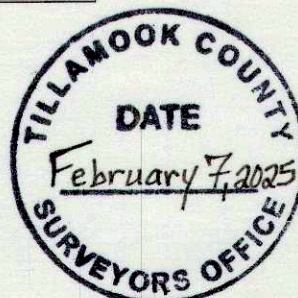

BOOK 8 213